

Description of the ELEKTRA SelfTec antifrost system

Even in the most adverse winter weather, the ELEKTRA SelfTec system protects water supply lines, valves, gutters, cylinders and other objects which are likely to fail due to low temperatures.

Easy assembly

The ELEKTRA SelfTec system is designed to be laid directly on the protected part such as a pipe, a valve, or a gutter. You may install the SelfTec system on plastic products as well. Unlike other heating cables, the ELEKTRA SelfTec selfregulating cable stays flexible even in low temperatures and is easy to remove.

Operational comfort

The ELEKTRA SelfTec system operates any time it is needed. You do not need to think any more of unexpected weather or air temperature changes. The system automatically adjusts the cable temperature so that the basic condition is met.

Reliable design

The cable core is made of crosslinked polymer with an addition of carbon, and spread between two parallel copper conductors. The power is supplied from one end only. This design allows for a failure-free operation: in case of a local overheating, it is just that part which does not operate, and all of the remaining cable length keeps its properties. A tin-covered copper-wire braided screen protects the core without decreasing the cable flexibility. The external coat made of modified polyolefins largely improves the mechanical specification of the cable.

Selfregulation

The selfregulation of heating cables is their capability to vary the power output (heat) when exposed to the changing environment conditions (temperature). The diagram presents the relation between the cable temperature and the pipeline (water supply) temperature. After the system has been switched on, while the pipe is still cool (blue), the heating cable "warms up" and delivers more power (red). When the pipe is warmer, the cable operates with less power and "cools down".

The adjustment of the heat emitted by the cable is automatic. Thanks to that, the heating cable may be laid multi-layered,

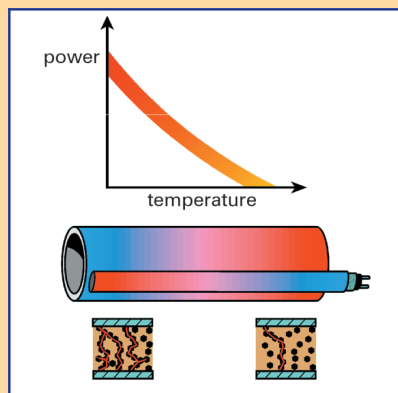

does not need to have a special thermal insulation, its position may be changed. The ELEKTRA SelfTec system is supplied from 230V AC network. Both simulated operation and practical tests confirm the operational comfort and dependability. The ELEKTRA SelfTec system keeps pipelines operable, protects buildings and people even at low winter temperatures.

Install the ELEKTRA SelfTec now, and you will forget your troubles with frozen pipelines and gutters in a cold winter.

Installation of the selfregulating cable

Depending on the application, two installation methods are adopted:

On pipelines:

1. along the pipe.

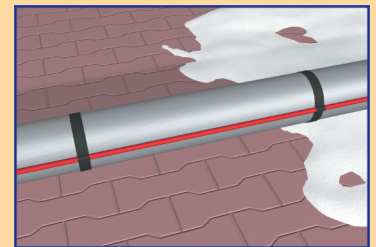

2. round the pipe.

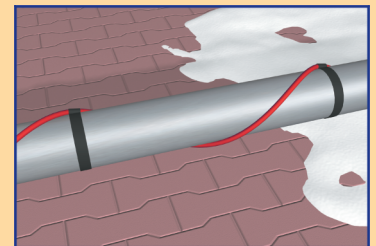

On valves

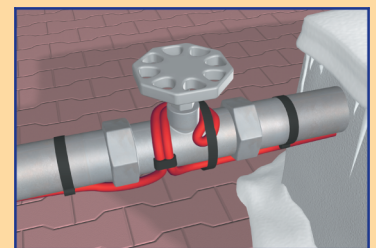

In gutters and down pipes

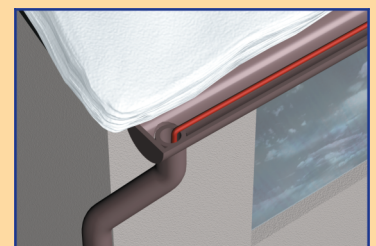

The ELEKTRA SelfTec antifrost protection system		
Power output (W/m) at 5°C		16
Supply voltage (V)		230
Maximum bending radius (mm)	10	
Maximum exposure temperature (°C)	Intermittent	85
	Continuous	65
Maximum dimensions	Thickness (mm)	6.0
	Width (mm)	8.5
Outer jacket colour		black
Maximum length	meters	80



Heating Solutions



10 YEAR GUARANTEE

DEALER